

- |                                      |         |      |
|--------------------------------------|---------|------|
| ACADEMIC OFFICE BLOCK                | AOB     | G-12 |
| ADVANCED TECHNOLOGY CENTRE           | A T C   | G-10 |
| ANIMAL FEED STORE                    | AF      | J-18 |
| ANIMAL HOUSE                         | A N     | F-10 |
| ARCHITECTURE                         | A       | G-3  |
| ARCHITECTURE DESIGN STUDIO           | A D S   | G-3  |
| ART                                  | A T     | J-10 |
| ART GRADUATE WORKSHOP                | M W     | J-9  |
| AVIATION                             | AV      | H-2  |
| BARAHINEBAN                          | BAR     | K-17 |
| BASDEN THEATRE                       | BASDEN  | J-2  |
| BEHAVIOURAL SCIENCES BUILDING        | W       | L-4  |
| BIOLOGICAL SCIENCES                  | B       | J-2  |
| BIOLOGICAL SCIENCES GLASSHOUSES      | BGH     | J-1  |
| BIRABAHN                             | SAS     | L-8  |
| BOWMAN BUILDING                      | BB      | J-11 |
| BSC. BUILDING                        | B S C   | G-3  |
| CERAMICS                             | C E     | K-9  |
| CHANCELLERY (central administration) | C H     | F-7  |
| CHEMISTRY BUILDING                   | C       | K-2  |
| CHILD CARE CENTRE - KINTAIBA         | C C K   | N-7  |
| CHILD CARE CENTRE - KOOINDA          | C C B   | N-7  |
| CHILD CARE CENTRE - WONNAYBA         | C C W   | J-11 |
| COMMONWEALTH BANK                    | C B     | I-9  |
| COMPUTING & INFORMATION SCIENCES     | C T     | L-5  |
| DESIGN BUILDING                      | D       | K-9  |
| DRAMA BUILDING                       | DB      | K-3  |
| DRAMA STUDIOS                        | DS      | K-3  |
| DRAMA THEATRE                        | DT      | K-4  |
| EARTH SCIENCES CORE SHED             | ESCS    | L-1  |
| EDWARDS HALL                         | E H     | K-15 |
| ENGINEERING ADMINISTRATION           | E A     | H-7  |
| ENGINEERING BULK SOLIDS              | E G     | F-8  |
| ENGINEERING CHEMICAL & MATERIALS     | E B     | G-8  |
| ENGINEERING CIVIL & SURVEYING        | E D     | G-8  |
| ENGINEERING CLASSROOMS               | E F     | H-6  |
| ENGINEERING ELECTRICAL & COMPUTER    | E E     | G-6  |
| ENGINEERING MECHANICAL               | E C     | F-7  |
| ENGINEERING SCIENCE ( DW GEORGE )    | E S     | G-6  |
| EVATT HOUSE                          | E V     | K-12 |
| FRIENDS SHED                         | F S     | C-11 |
| GALLERY : SCHOOL OF FINE ART         | G S     | K-10 |
| GENERAL PURPOSE BUILDING             | G P     | K-5  |
| GEOLOGY BUILDING                     | G       | L-2  |
| GREAT HALL                           | G H     | M-2  |
| GRIFFITH DUNCAN THEATRE              | HGDT    | I-12 |
| HEALTH & PHYSICAL EDUCATION          | H P E   | D-10 |
| HUNTER BUILDING                      | H       | I-11 |
| INDUSTRY DEVELOPMENT CENTRE          | I D C   | N-6  |
| INTERNATIONAL HOUSE                  | I       | M-14 |
| ISLAMIC PRAYER CENTRE                | I P     | I-12 |
| LANGUAGE CENTRE                      | L C     | I-4  |
| LIBRARY - AUCHMUTY                   | L       | I-3  |
| LIBRARY - HUXLEY                     | H       | I-11 |
| LIFE SCIENCES                        | L S     | I-2  |
| LIFE SCIENCES THEATRE                | L S T H | J-2  |
| MATHEMATICS BUILDING                 | V       | L-4  |
| McMULLIN BUILDING                    | M C     | L-3  |
| McMULLIN THEATRE                     | M C T H | L-3  |
| MEDICAL SCIENCES BUILDING            | M S     | I-2  |
| NURSING                              | R W     | G-11 |
| NURSING LECTURE THEATRE              | NURSTH  | G-11 |
| NUSA BUILDING                        | A E     | H-9  |
| NUSPORT COTTAGE                      | N C     | H-13 |
| OVALS MACHINERY SHED                 | O M S   | F-11 |
| OVALS TOOL SHED                      | O T S   | F-11 |
| PHYSICS BUILDING                     | P       | K-1  |
| RADIO 2NURFM                         | L C     | I-4  |
| RAY WATT OVAL PAVILION               | R W O P | I-17 |
| RESEARCH COTTAGE                     | R C     | L-14 |
| RICHARDSON WING                      | R W     | G-11 |
| SECURITY                             | M C     | L-3  |
| SCIENCE BUILDING                     | S B     | K-1  |
| SCIENCE THEATRE                      | S T H   | K-2  |
| SCULPTURE WORKSHOPS                  | S W     | J-10 |
| SERVICES BUILDING                    | S E R   | M-10 |
| SOCIAL SCIENCES BUILDING             | S R     | K-4  |
| SPECIAL EDUCATION CENTRE             | S E     | K-11 |
| SPORTS & AQUATIC CENTRE (THE FORUM)  | S C H   | D-11 |
| SPORTS PAVILION                      | S P     | H-14 |
| STUDENT SERVICES CENTRE              | S C     | I-10 |
| THE TEACHING CENTRE                  | T C     | G-12 |
| THE STATION                          | S T     | H-12 |
| TRACTOR GARAGE                       | T G     | B-11 |
| TUNRA ANNEXE                         | T A     | F-7  |
| UNIVERSITY CLUB                      | S H     | K-4  |
| UNIVERSITY UNION - HUNTER            | U H     | H-9  |
| UNIVERSITY UNION - SHORTLAND         | U S     | J-4  |
| VISUAL ARTS / MEDIA STUDIES          | V A     | K-10 |
| WETLANDS PAVILION                    | W P     | E-7  |

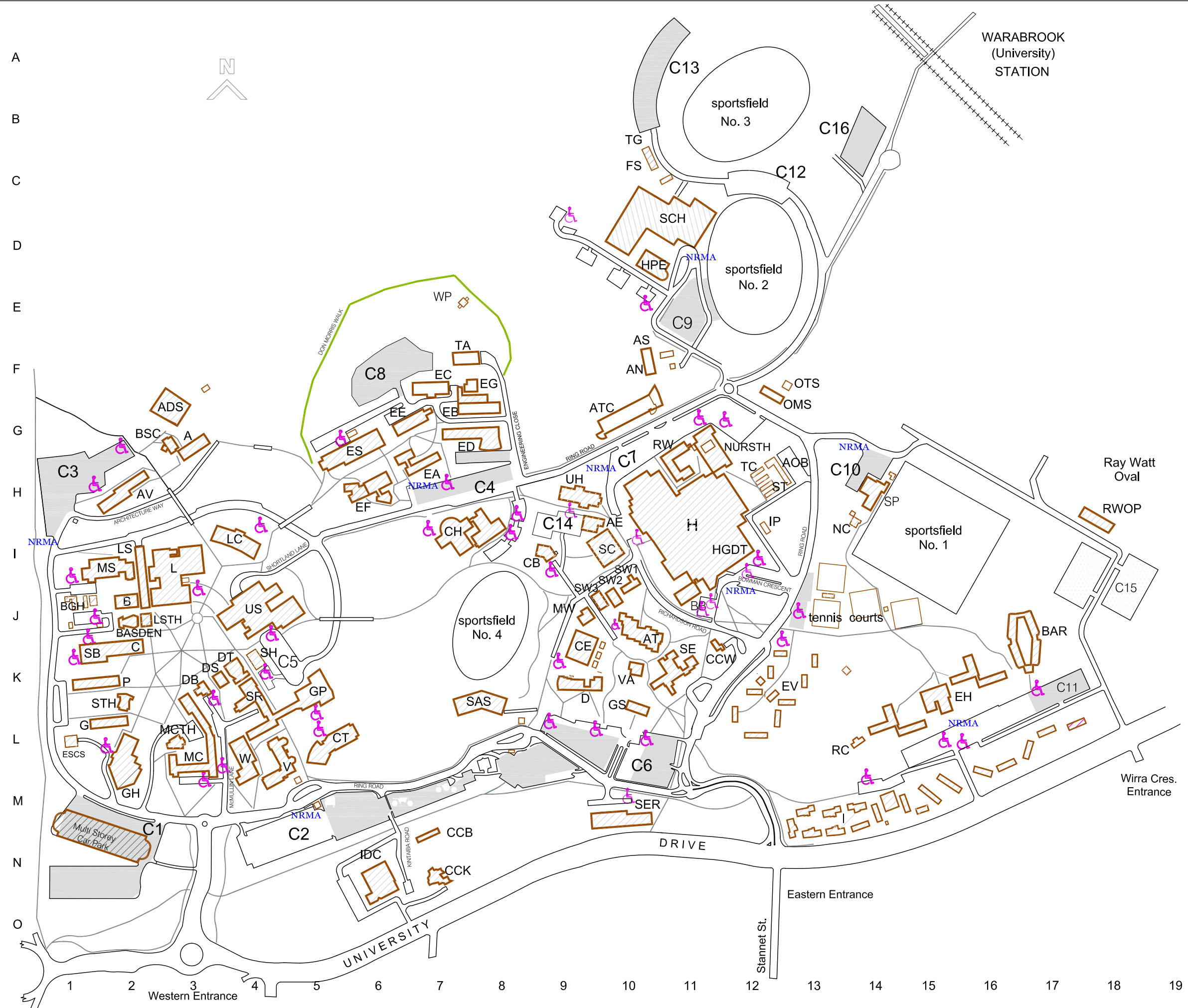

WARABROOK  
(University)  
STATION

VISITOR/STUDENT GENERAL PARKING.  
 DISABLED PARKING.  
 NRMA MEETING PLACE

# CAMPUS PLAN

The University of Newcastle